

FERRARI

92

COFANO MOTORE
 CAPE MOTOR
 ENGINE COVER

CAPO MOTOR
 COFFRE MOTOR
 MOTORHAUBE

PAGINA
01.00
DATA
- 1 LUG. 1990

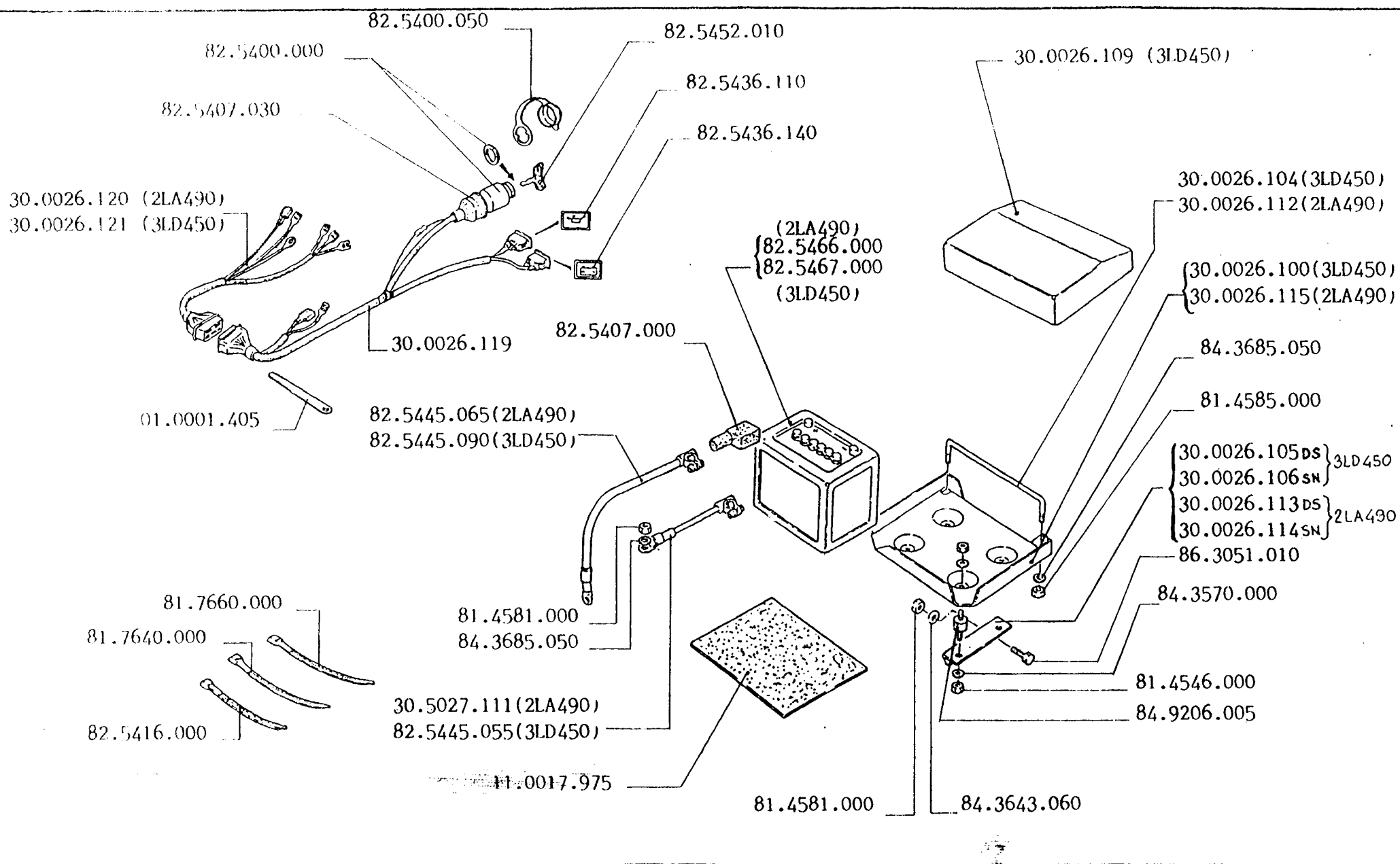

FERRARI

92

AVVIAMENTO ELETTRICO
 SISTEMA ELECTRICO
 ELECTRIC STARTER

ARRANQUE ELECTRICO
 DEMARRAGE ELECTRIQUE
 ELEKTROSTART

PAGINA

02.00
DATA

- 1 LUG. 1990

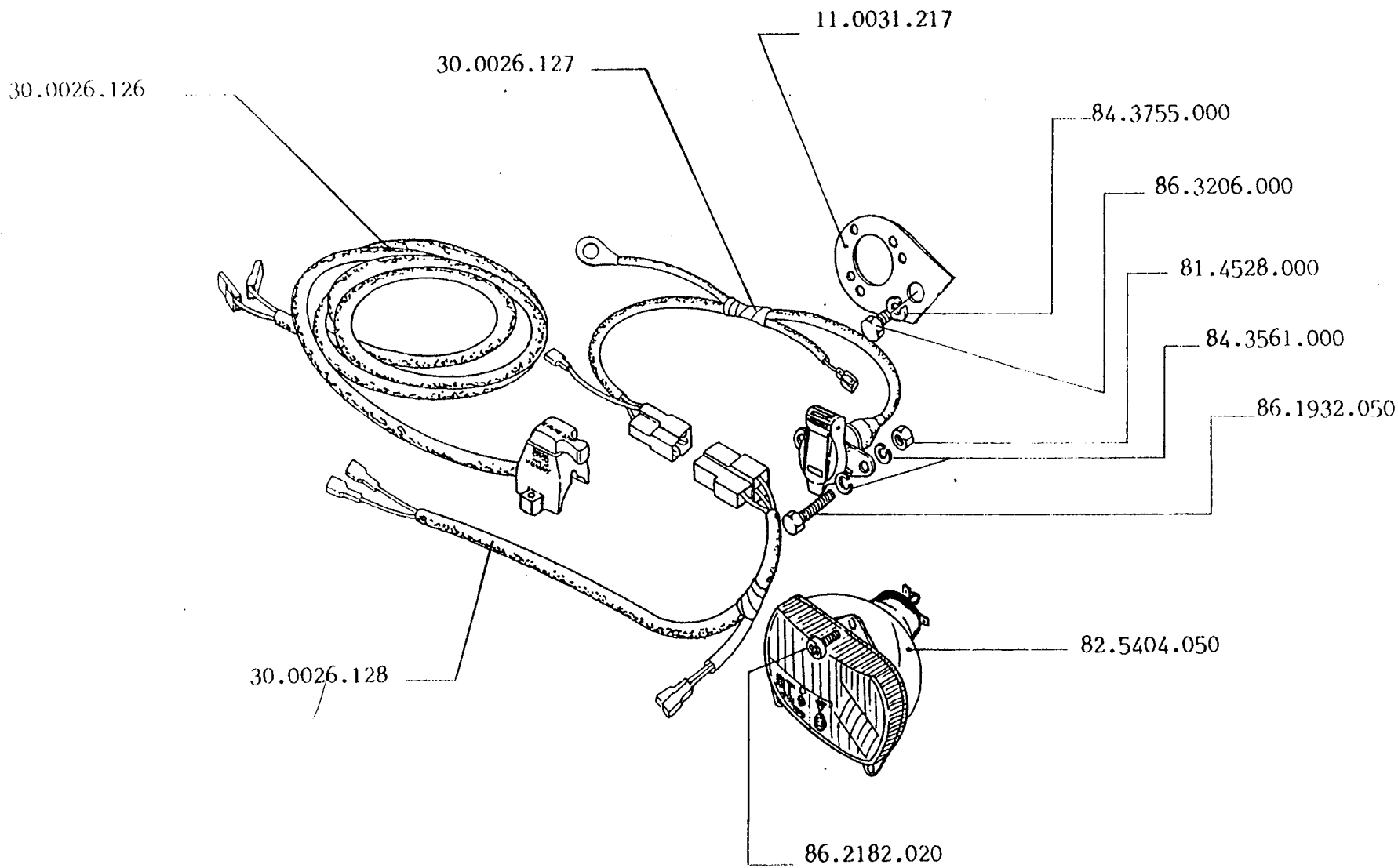

FERRARI

92

AVVIAMENTO ELETTRICO
 SISTEMA ELETTRICO
 ELECTRIC STARTER

ARRANQUE ELECTRICO
 DEMARRAGE ELECTRIQUE
 ELEKTROSTART

PAGINA
03.00
DATA

- 1 LUG. 1990

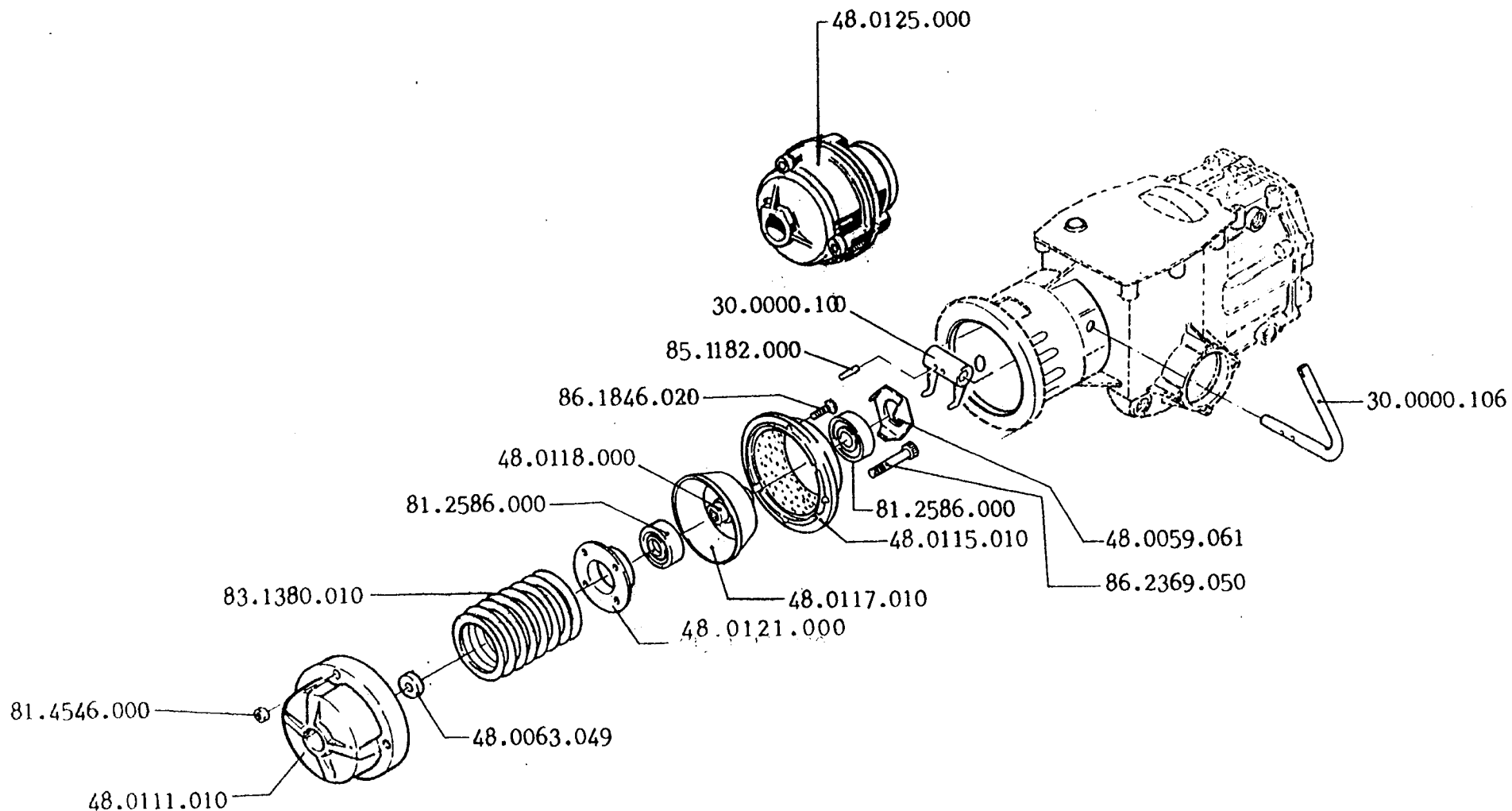

FERRARI

92

FRIZIONE CONICA
 EMBREAGEM CONICA
 CONIC CLUTCH

EMBRAGUE CONICA
 EMBRAYAGE CONIQUE
 KUPPLUNG

PAGINA
 04.00
 DATA
 - 1 LUG. 1990

81.9010.050 (2LA490-3LD450)

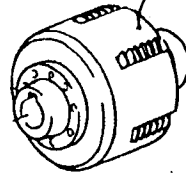

84.3559.030

86.1932.050

28.0000.206

28.0000.201

30.0008.343

28.0000.203

48.0059.061

81.2504.010

81.2586.000

28.0000.199

28.0000.205

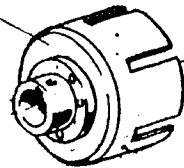

28.0000.204

30.0000.107

28.0000.202

92

FERRARI

FRIZIONE A DISCHI	EMBRAGUE A DISCOS
EMBRAIAGEM A DISCOS	EMBRYAGE A DISQUES
DISC CLUTCH	MEHRSCHEIBENKUPPLUNG

PAGINA

05.00

DATA

- 1 LUG. 1990

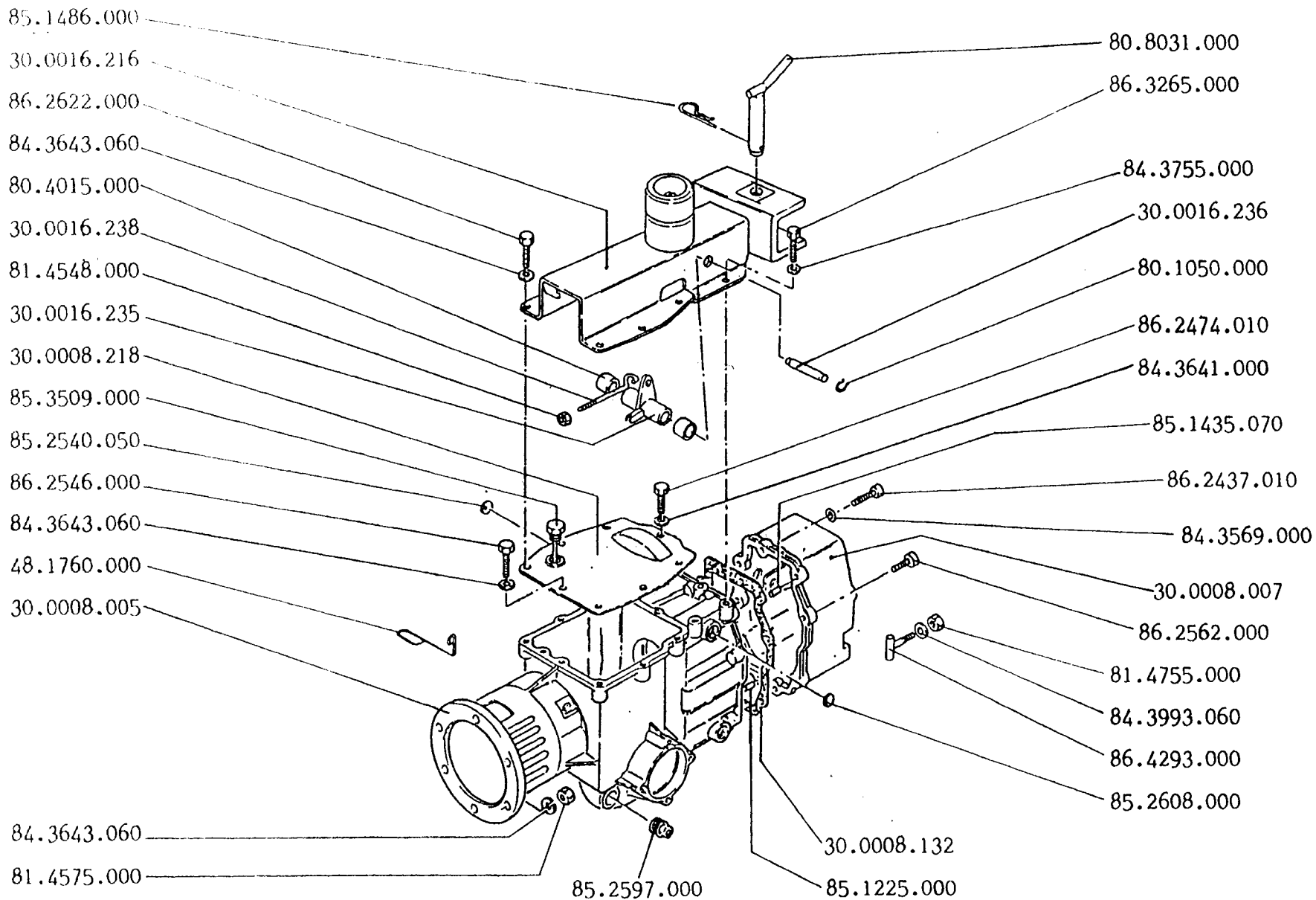

FERRARI

92

SCATOLA CAMBIO
 CAIXA DE COMANDO
 GEARBOX

CAJA DE CAMBIO
 BOITE DE VITESSES
 WECHSELGETRIEBE

PAGINA

06.00

DATA

- 1 LUG. 1990

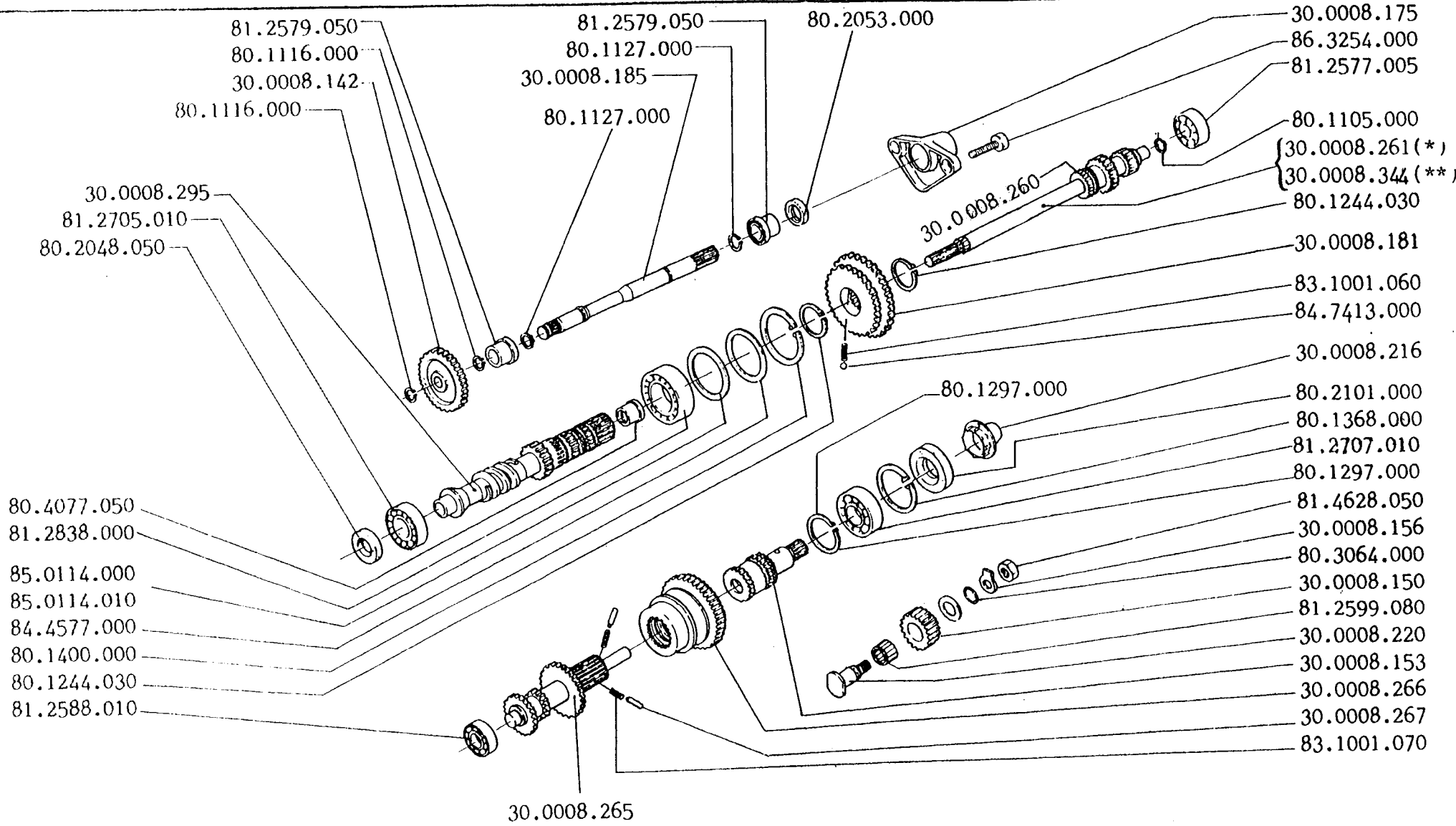

(*) Per frizione normale.

(**) Per frizione a dischi.

FERRARI

92

INGRANAGGI CAMBIO
ENGRENAGEM
GEAR

ENGRENAJES
ENGRENAGES
ZAHNRADER

PAGINA
07.00
DATA
LUG. 1990

SMINCOLO
 FREE WHEELS
 ROUES LIBRES
 FREI RADERN

BLOCCAGGIO DIFFERENZ.
 LOCKING DIFFERENTIAL
 BLOCAGE DU DIFFERENT.
 DIFFERENTIALSPERRE

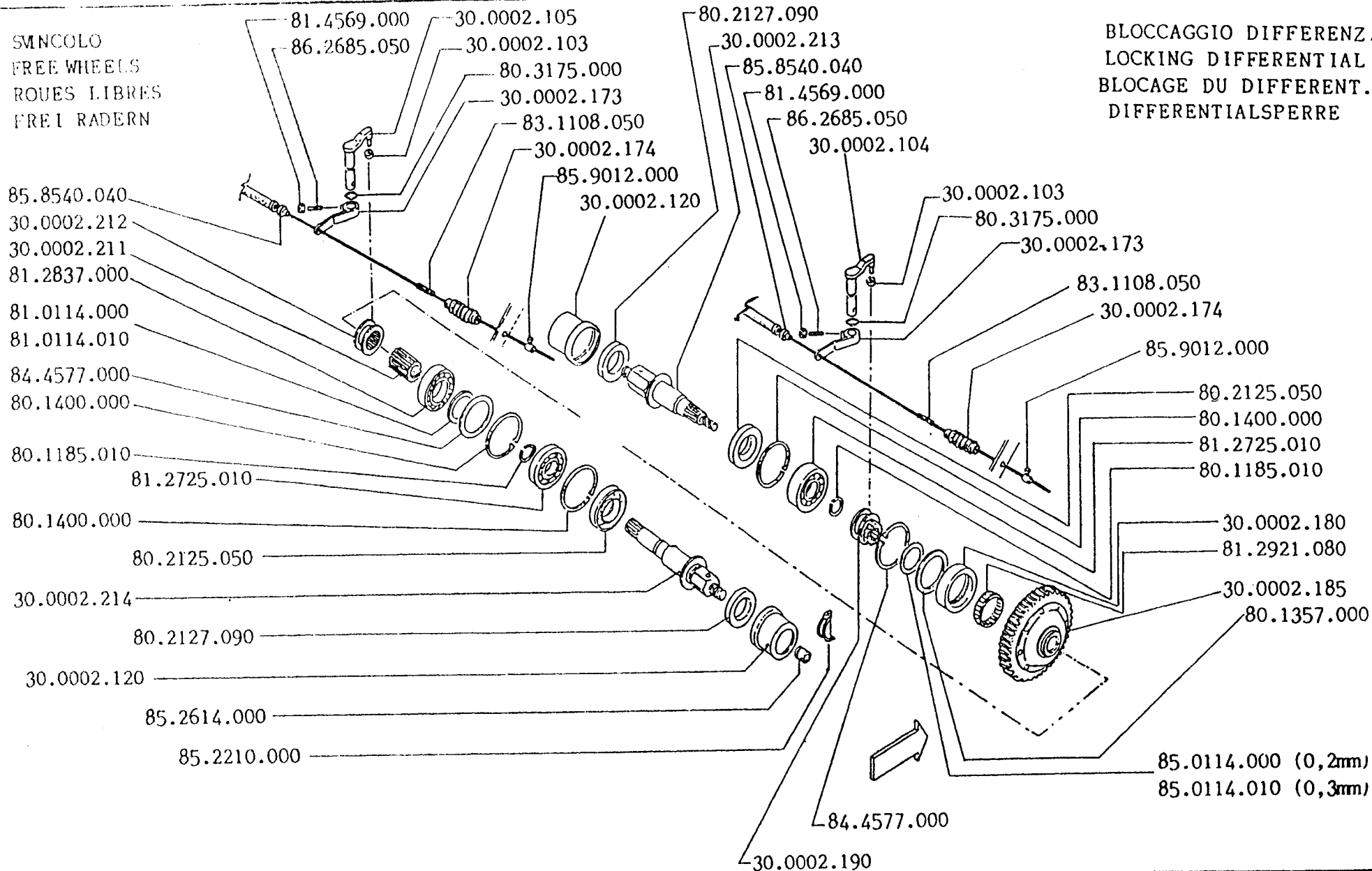

FERRARI

92

ASSE RUOTE
 AXIS RODAS
 WHEEL AXLE

EJE RUEDAS
 ESSIEU ROUES
 RADACHSE

PAGINA
 08.00
 DATA
 - 1 LUG. 1990

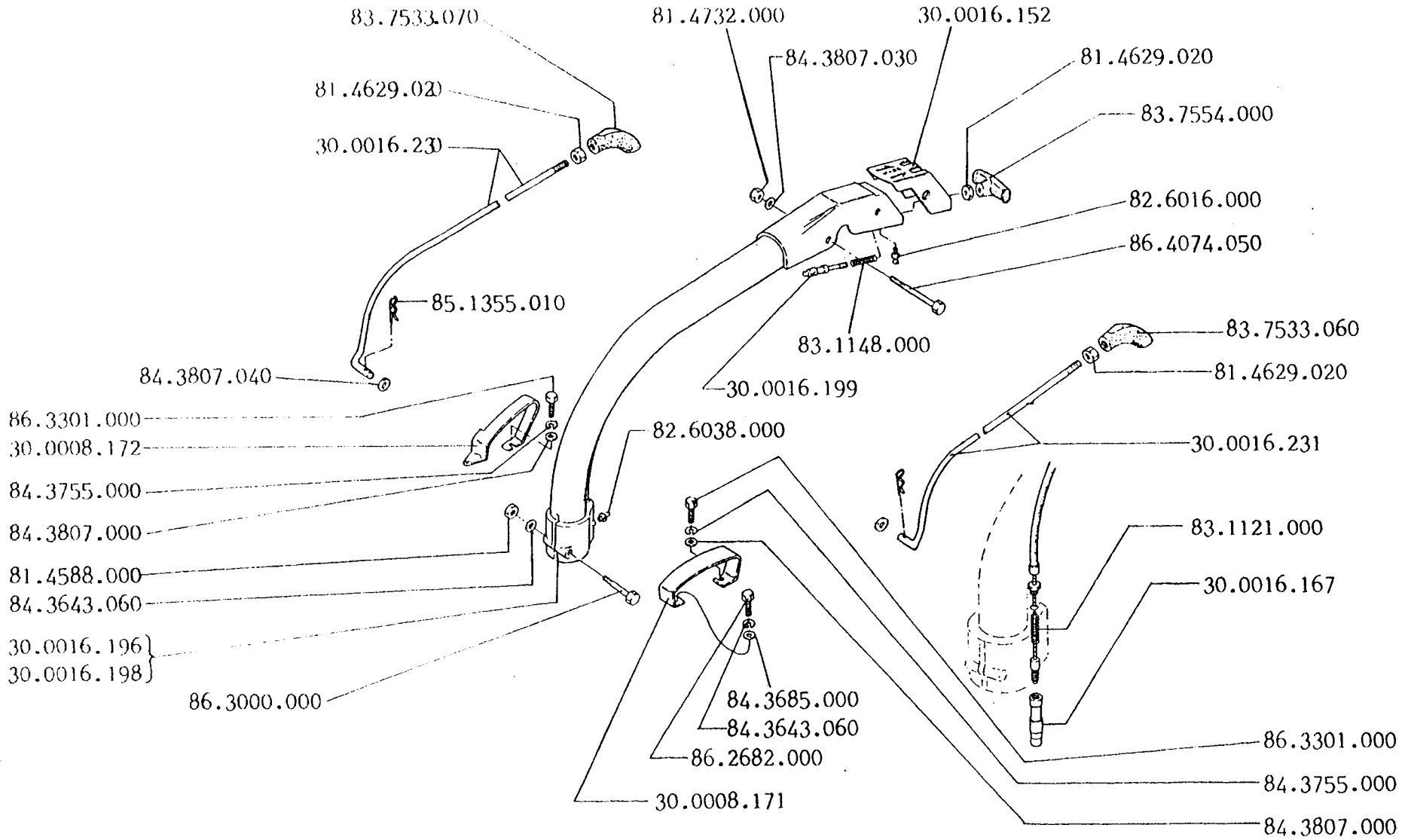

FERRARI

92

COMANDI
COMANDES
CONTROLS

MANDOS
COMMANDES
ANTRIEBE

PAGINA
09.00
DATA
LUG. 1990

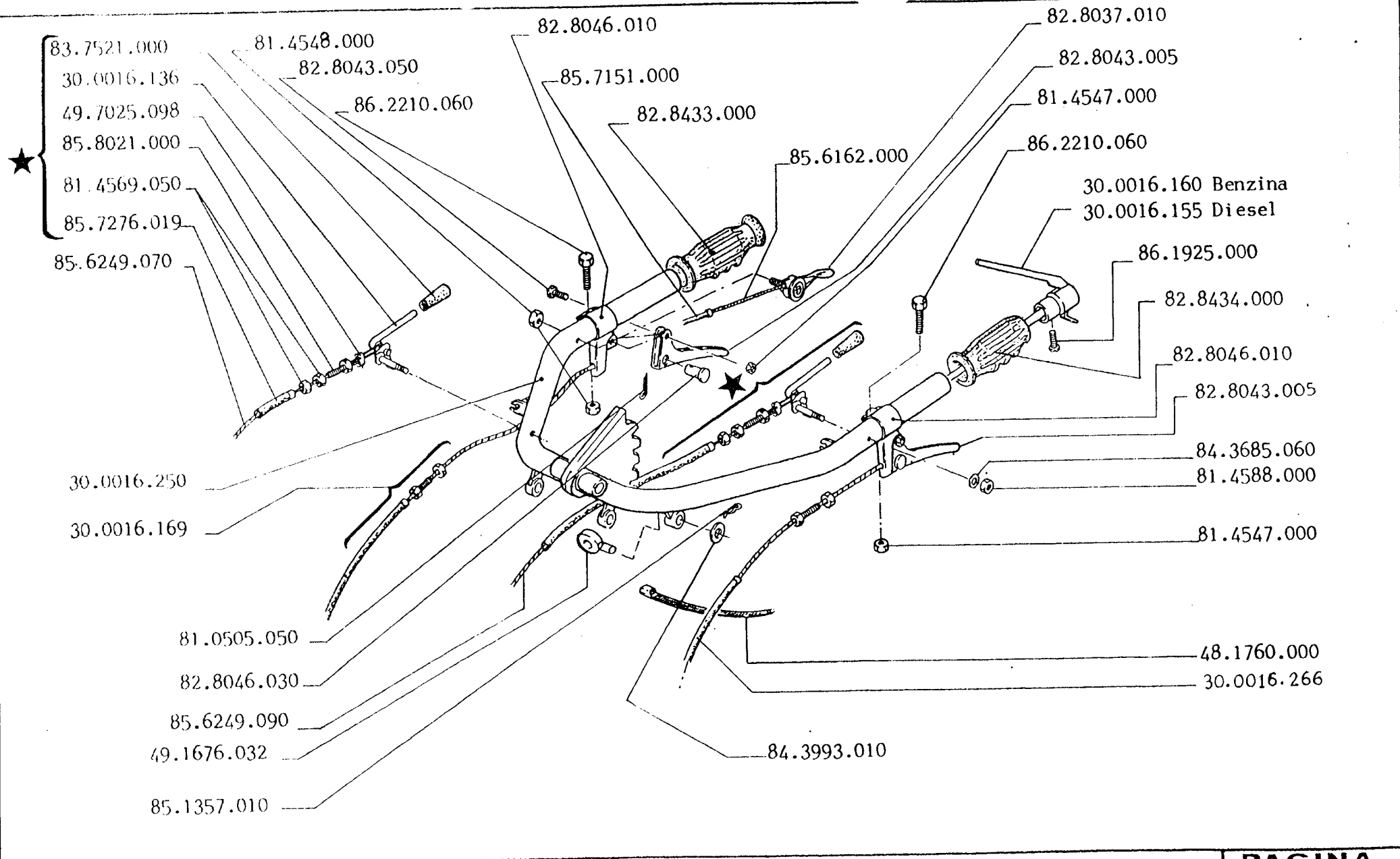

FERRARI

92

MANUBRIO
 MANUBRIO
 HANDLEBAR

MANILLAR
 MANCHERON
 LENKER

PAGINA
10.00
DATA
 - 1 LUG. 1990

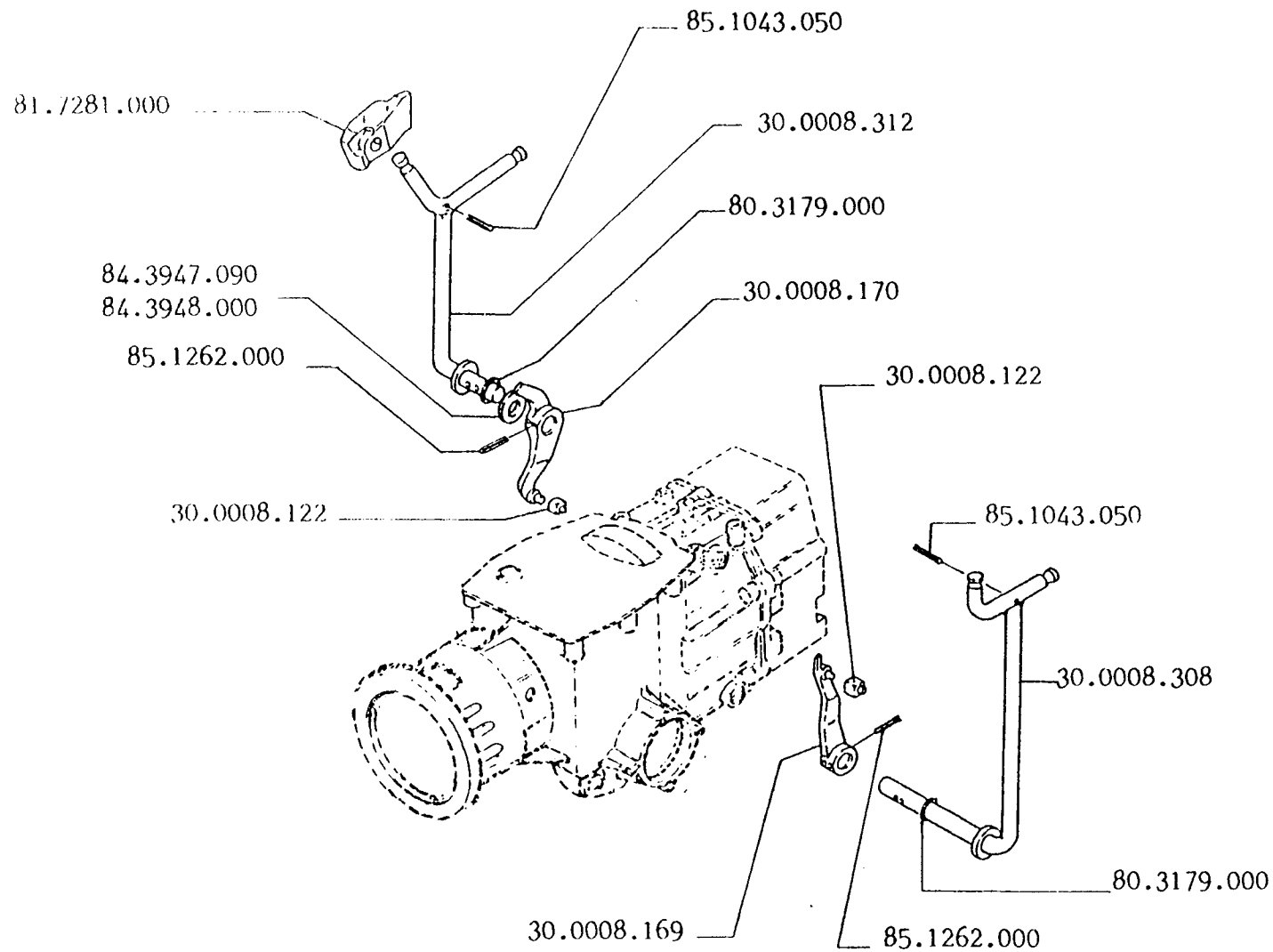

FERRARI

92

COMANDI INTERNI
 COMANDOS INT.
 INTERN CONTROL

MANDOS INT.
 COMMANDES INT.
 ANTRIEBE INNEN

PAGINA
11.00
 DATA

1 LUG. 1990

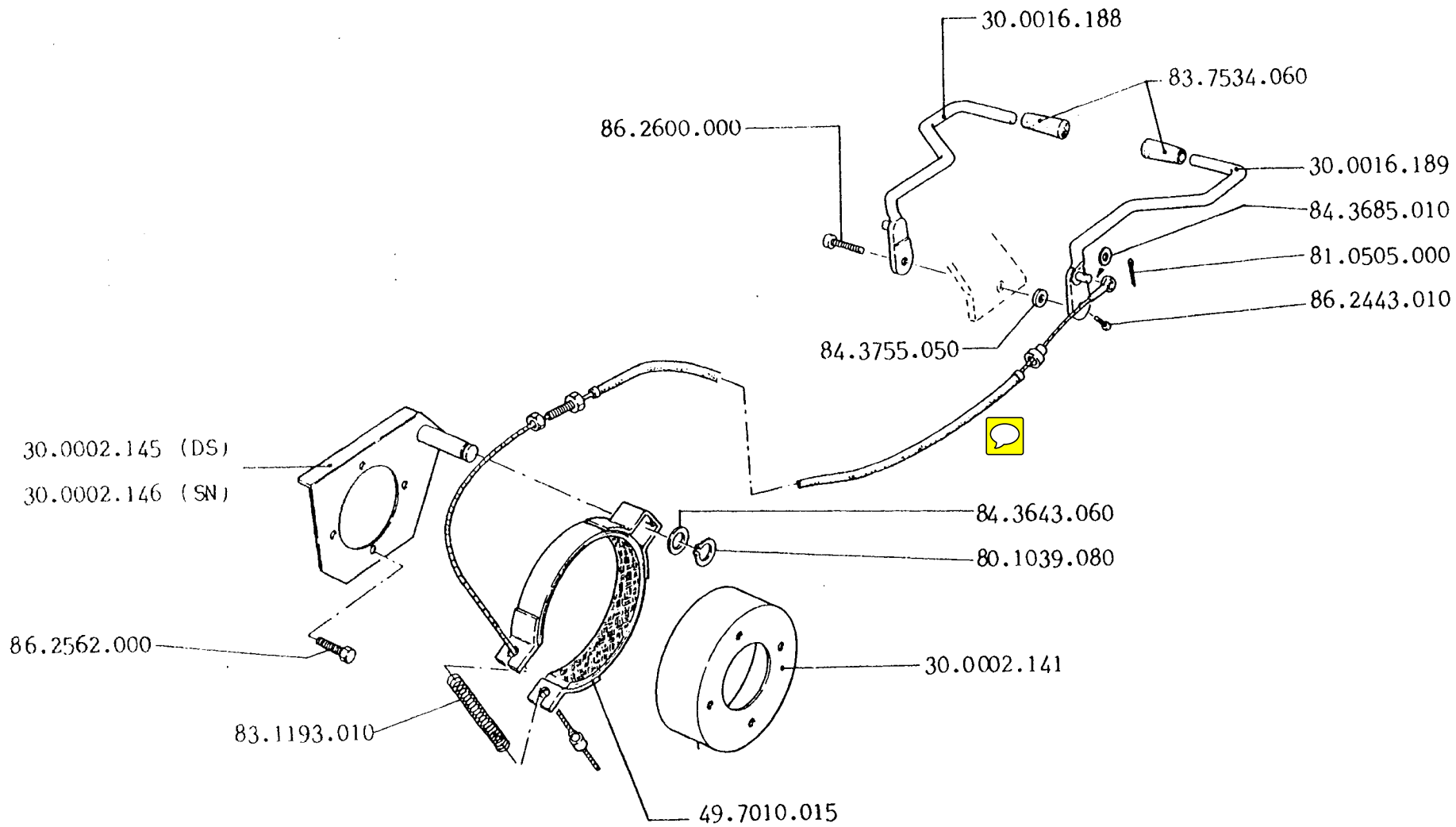

FERRARI

92

FRENI
 TRAVOES
 BRAKES

FRENOS
 FREINS
 BREMSEN

PAGINA
 12.00
 DATA
 1 LUG. 1990

84.8538.000

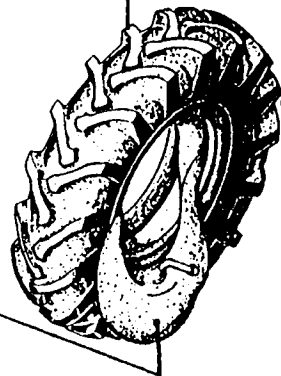

84.8832.000

30.0050.139 DS.
30.0050.140 SN.

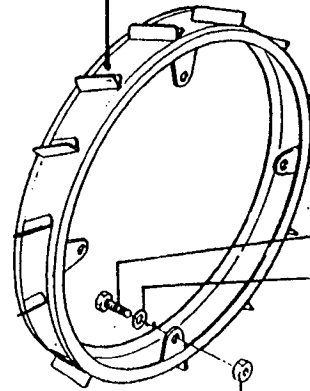

86.3254.000

84.3755.000

81.4644.000

84.9024.000

84.9024.010

81.4644.000

84.3755.000

84.9017.030

86.3254.000

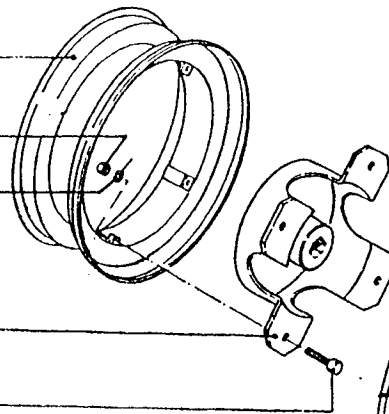

30.0050.168 DS
30.0050.169 SN

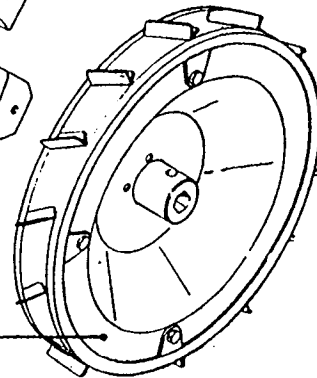

30.0050.160

81.4621.000

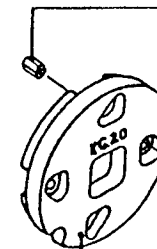

84.3818.040

86.3359.000

84.3755.000

FERRARI

92

RUOTE
RODAS
WHEELS

RUEDAS
ROUES
RADER

PAGINA
13.00
DATA
1 LUG. 1990

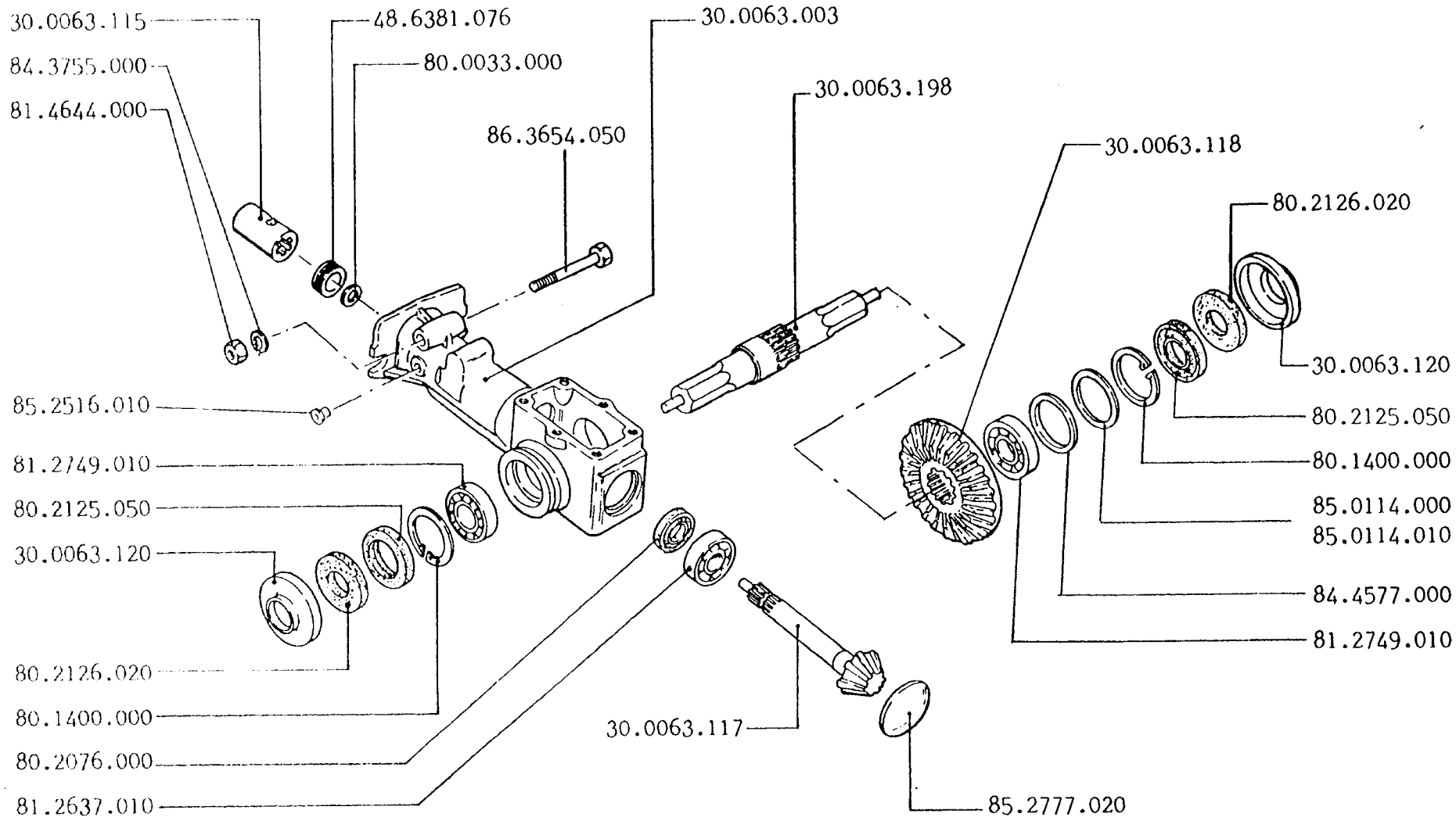

FERRARI

92

FRESA
 FRESA
 ROTARY HOE

FRESADORA
 FRAISE
 FRASER

PAGINA
14.00
 DATA
 - 1 LUG. 1990

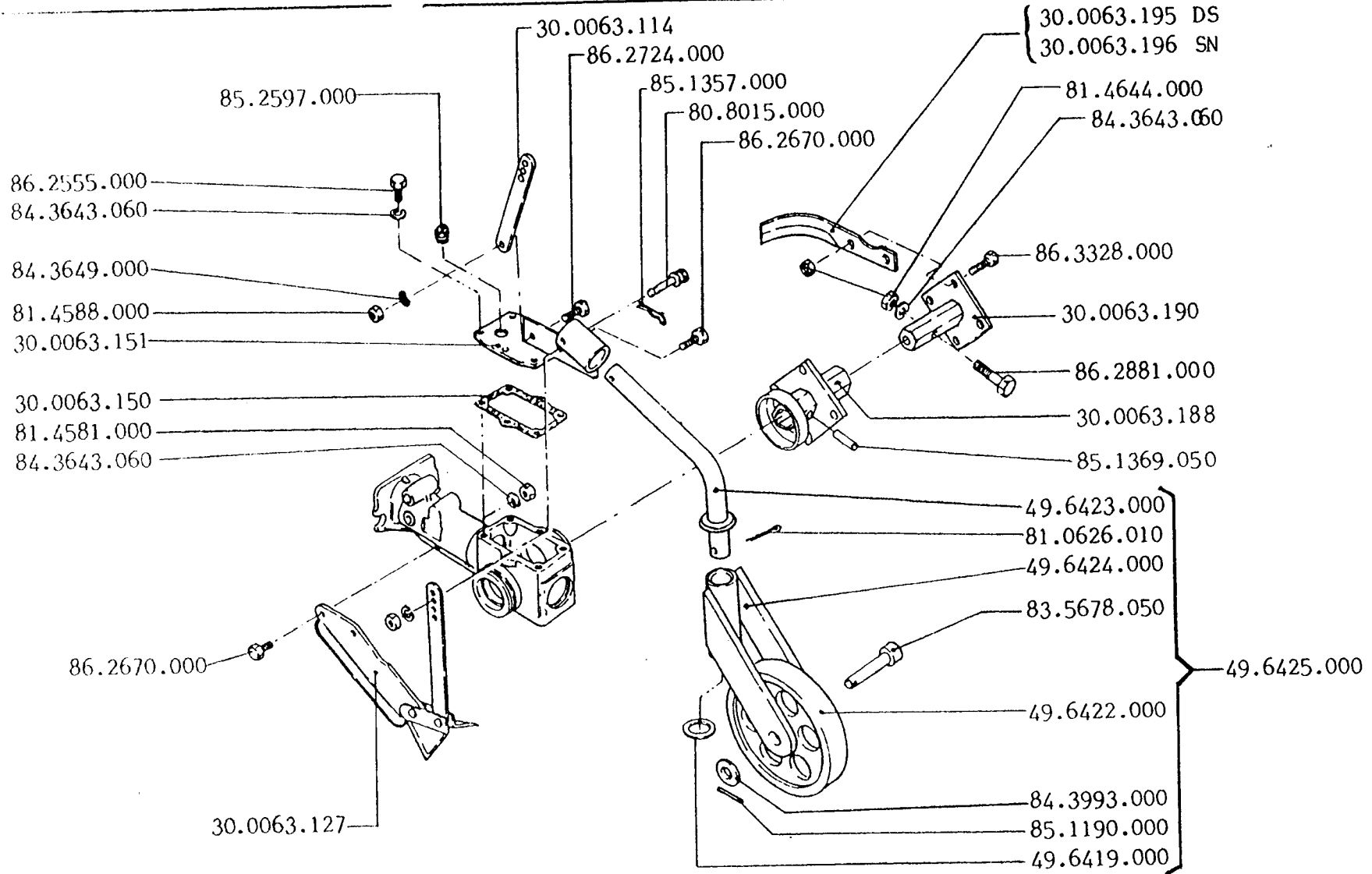

FERRARI

92

FRESA
FREZA
ROTARY HOE

FRESADORA
FRAISE
FRASER

PAGINA
15.00
DATA
- 1 LUG. 1990

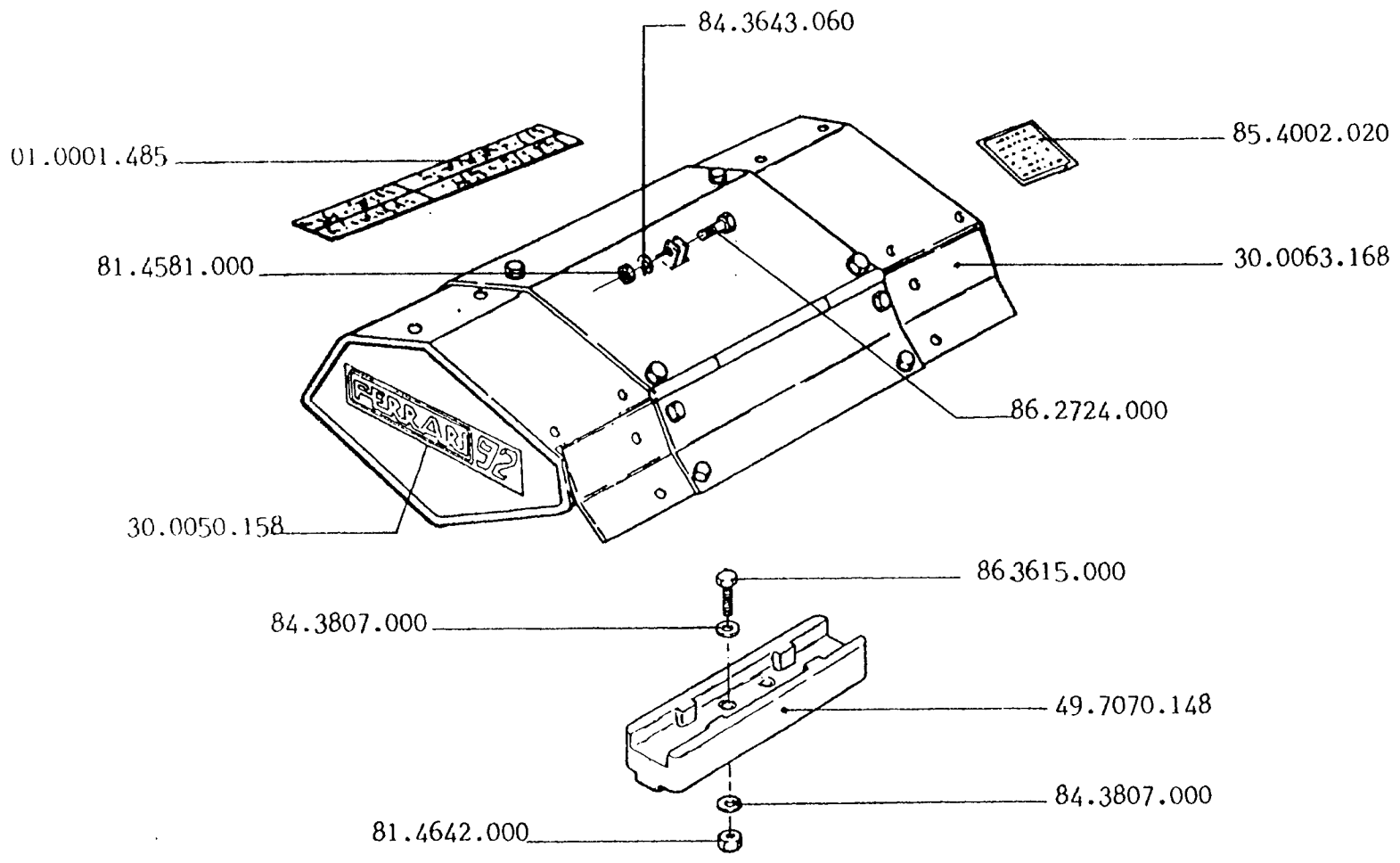

FERRARI

92

COFANO FRESA

CAPO FREZA

ROTEILN BOE HOOL

CAPO FRESADORA

COFFRE FRAISE

FRASERABDECKHAUBE

PAGINA

16.00

DATA

27 LUG. 1990

30.0026.110

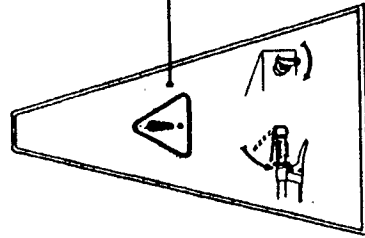

80.7170.000

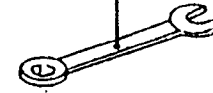

90.7170.018

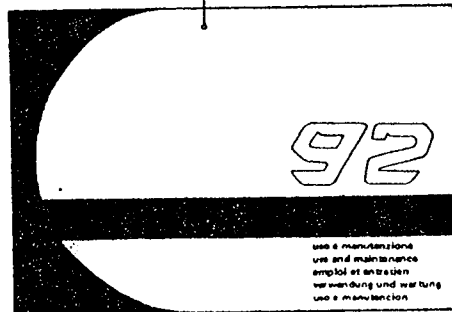

85.381.000

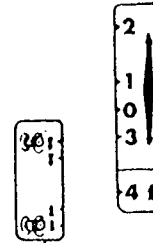

30.0008.187



30.0008.188

30.0000.102

FERRARI

92

ACCESSORI
ACESSORI
TOOL KIT

ACCESORIOS
AACCESSOIRES
WERKZEUGSATZ

PAGINA
17.00
DATA
- 1 LUG. 1990

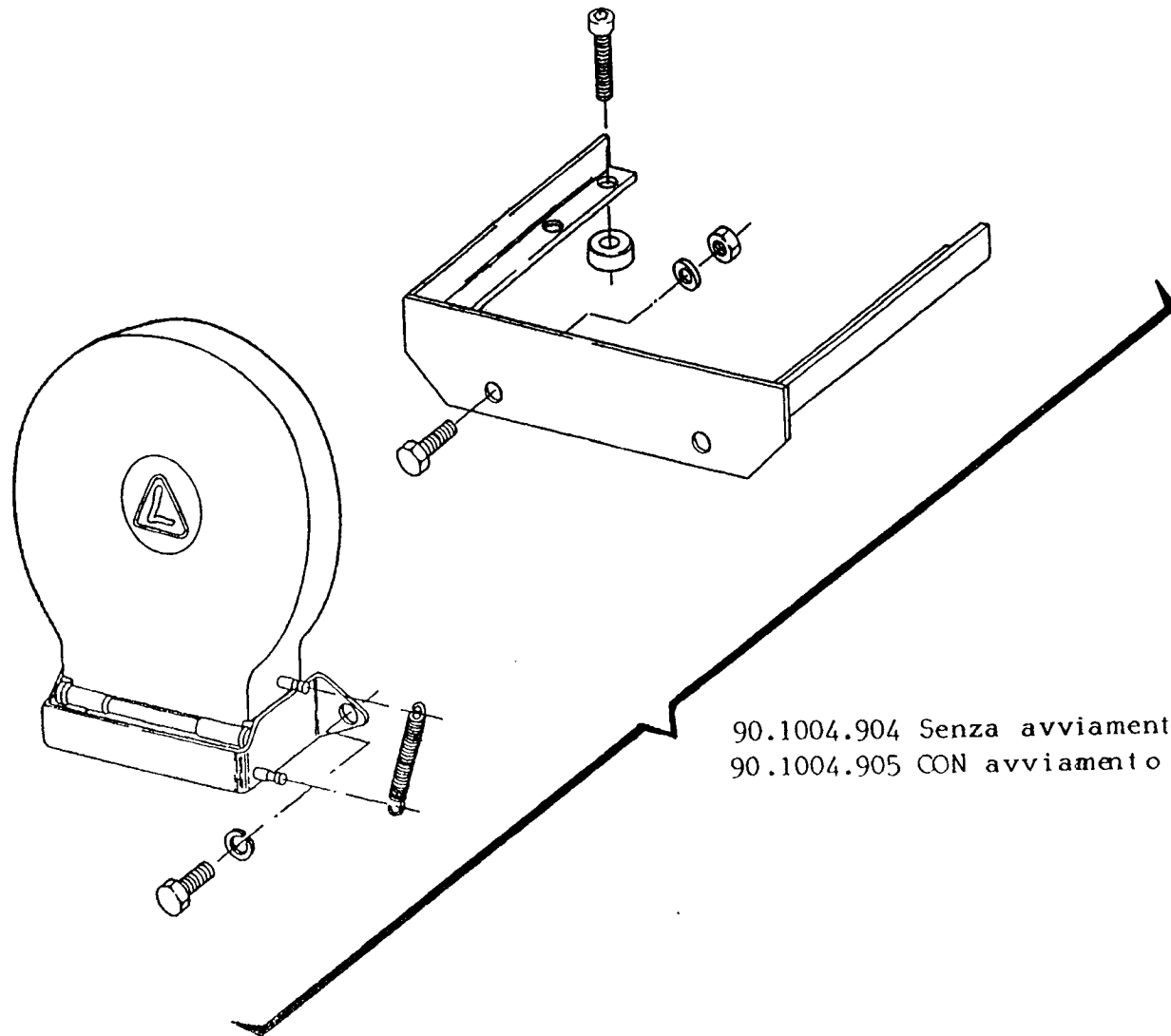

90.1004.904 Senza avviamento elettrico
 90.1004.905 CON avviamento elettrico

FERRARI

92

INSTRUMENTS

ACCESSOIRES

WERKZEUGSATZ

ACCESORIOS

ACCESSOIRES

WERKZEUGSATZ

PAGINA

18.00

DATA

11 LUG. 1990

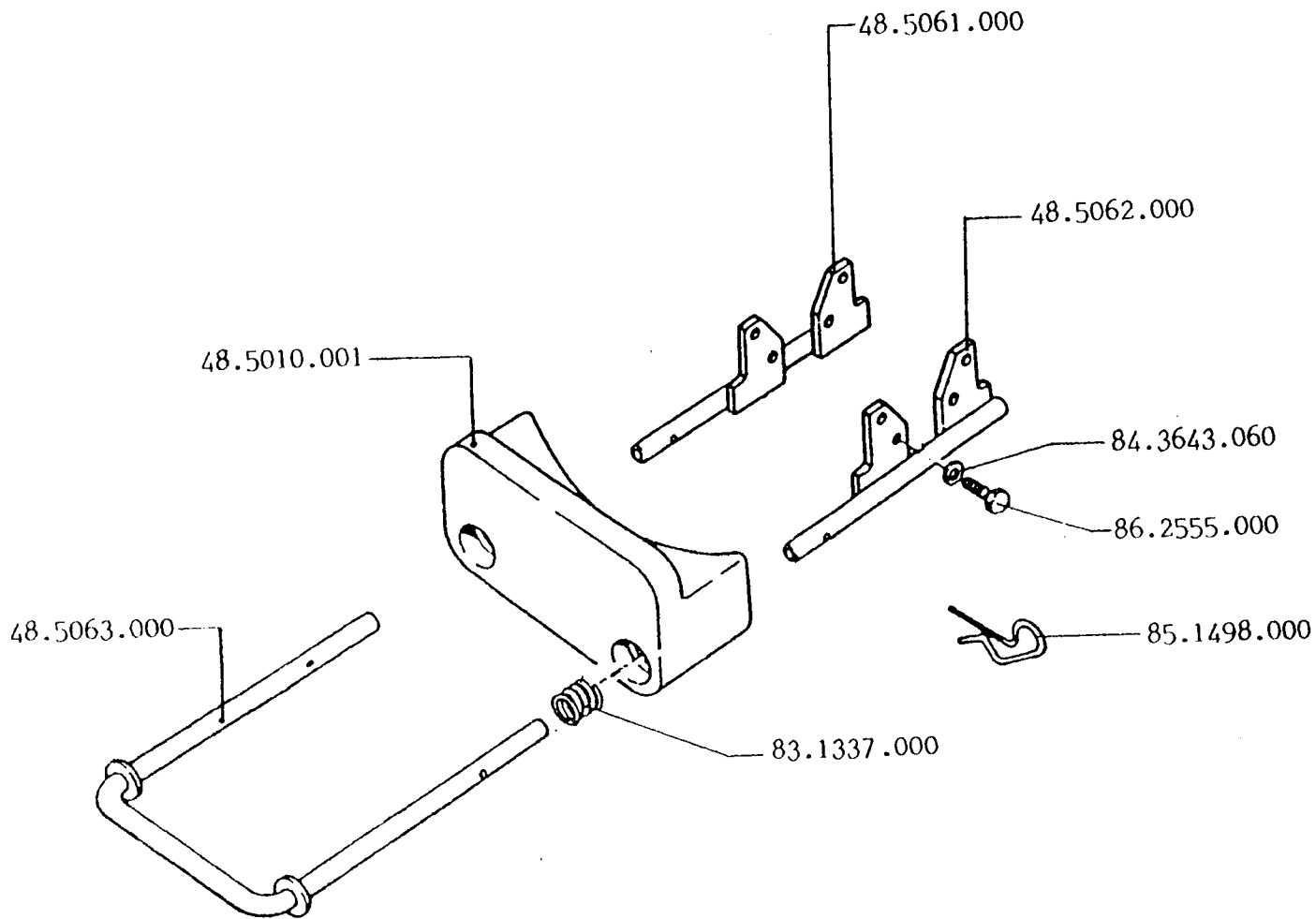

FERRARI

32

ACCESSOIRE
 ACCESSORIES
 TOOL KIT

ACCESSORIOS
 ACCESSOIRES
 WERKZEUGSATZ

PAGINA

19.00

DATA

1 LUG. 1990